

Roomba® 110-119 Combo Robot + AutoEmpty™ Dock

Owner's Guide

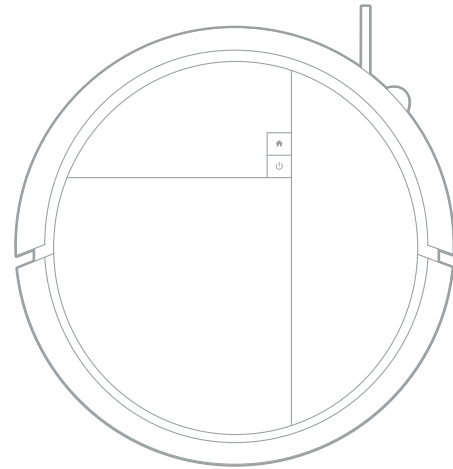

Getting started

1

Download the Roomba® Home App



Scan the QR code with the camera on your mobile device or find the Roomba® Home App in your app store.

The Roomba® Home App and a Wi-Fi® connection are **required to complete setup**. The Roomba® Home App will guide you through steps to set up your robot. Once your robot is set up, you can use the app to:

- Control when, where and how you clean
- Create automatic cleaning schedules
- Set custom cleaning preferences
- Unlock digital features
- Access tips, tricks and answers to commonly asked questions

NOTE:

2.4-GHz Wi-Fi must be used.

IMPORTANT:

Read the safety information guide first before using your robot.

2

Remove protective packaging

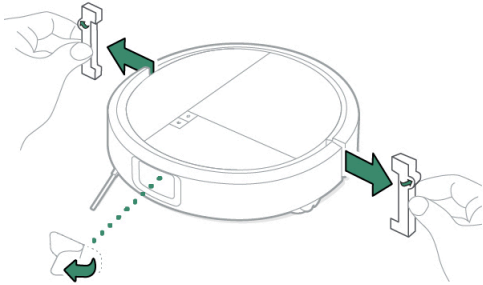

Remove the protective film from the camera and remove the foam inserts from behind the bumper.

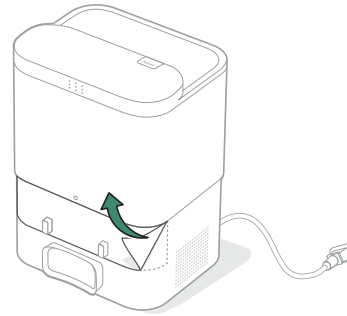

Remove protective film from IR window.

3

Install the Edge-Sweeping Brush

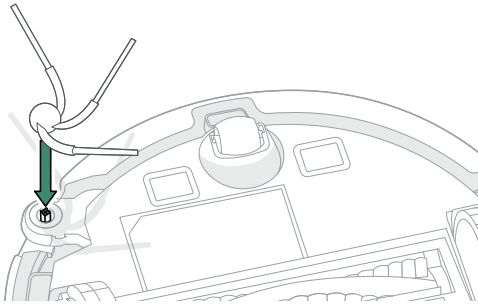

Align the Edge-Sweeping Brush and press down until you hear a click.

4

Place your dock

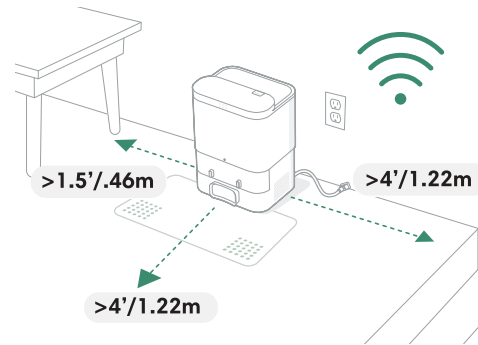

Place your dock on hard, level-surfaced flooring.

NOTE:

Do not place it in direct sunlight. Ensure that the area around the dock is free of clutter to improve docking performance.

WARNING:

To prevent the risk of your robot falling down stairs, ensure that your dock is placed at least 1.22 metres (4 feet) away from stairs.

5

Secure drip tray

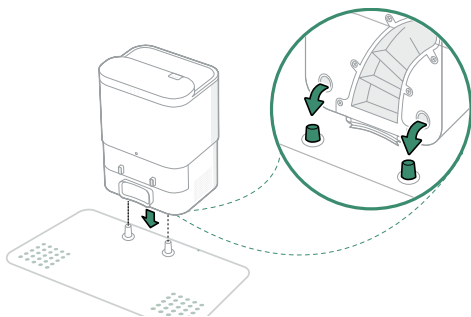

Place the dock onto the drip tray so that the alignment posts connect to the alignment post holes.

NOTE

Drip tray shown is an optional accessory and is not included with this product. Sold separately at global.irobot.com.

6

Plug in your dock

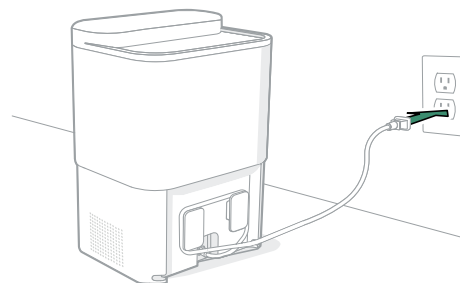

Plug the power cord into the back of the dock, then into a wall outlet. Wrap the cord on the back so it won't get in the way of the robot as it comes and goes.

7

Wake up your robot

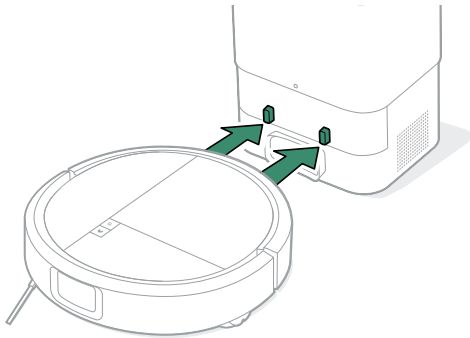

Place your robot in front of the dock, then slide it forwards until the metal charging contacts are lined up. Its lights will indicate that it's waking up. A sound will let you know it's fully awake.

NOTE:

Your robot comes with a partial charge, but we recommend letting it charge for 6 hours prior to creating a map of your home.

About your Roomba® Plus 110-119 Combo

Top view

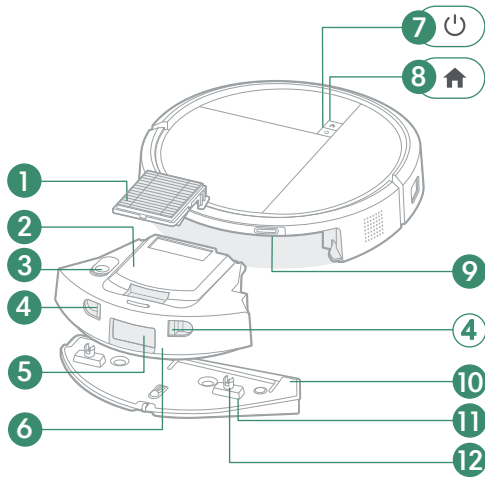

1. Filter
2. Bin top cover
3. Water port cover
4. Bin Release Button
5. Debris evacuation port
6. Bin
7. Power button
8. Home Button
9. Charging contacts
10. Pad plate
11. Pad plate attachment mechanisms
12. Pad plate gliding mechanisms

Bottom view

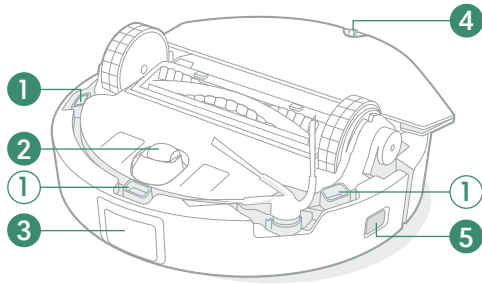

1. Cliff sensor
2. Caster wheel
3. IR window
4. Rear caster wheel
5. Wall sensor

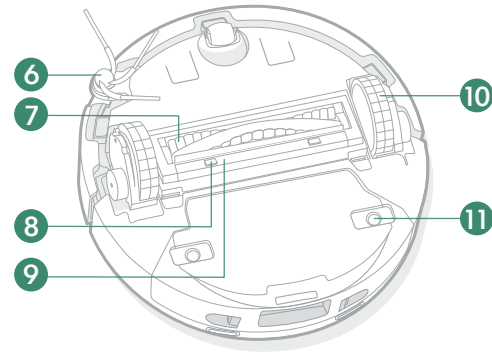

6. Edge-Sweeping Brush
7. Multi-Surface Brush
8. Multi-Surface Brush cover release tabs
9. Multi-Surface Brush cover
10. Wheels
11. Mop pad plate attachment port

About your AutoEmpty™ Dock

Front view

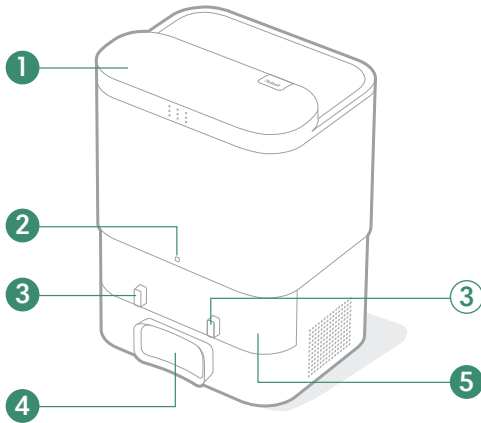

1. Dock lid
2. LED indicator
3. Charging contacts
4. Debris evacuation port
5. IR window

Top view

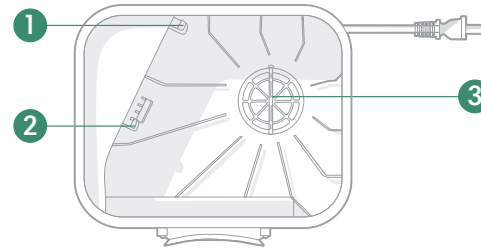

1. Bag alignment mechanisms
2. Dock filter
3. Dirt disposal bag storage

Rear view

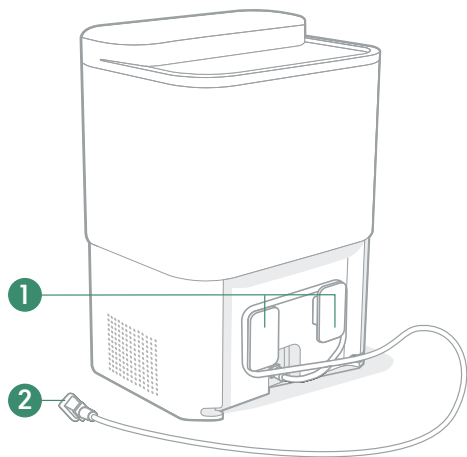

1. Cord wrap
2. Power cord

Rear view

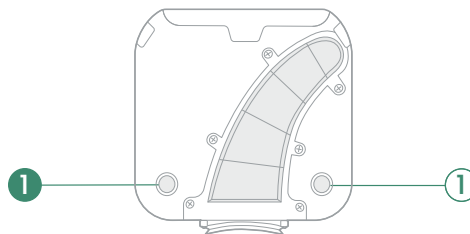

1. Cord wrap

Drip tray

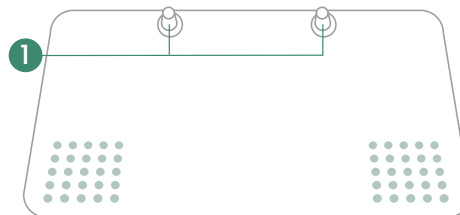

1. Alignment posts

NOTE

Drip tray shown is an optional accessory and is not included with this product. Sold separately at global.irobot.com.

Charging

Icon indicators



POWER and HOME Buttons

White – Fully charged and connected

Flashing white – Returning to dock to charge

Pulsing white – Charging/Low battery. Displays when robot's battery falls below 20% and it is charging or on its way to charge.



Flashing red – Error/Low battery. Displays when robot has an error or when it's off the dock and its battery falls below 20%.

For more information, visit global.irobot.com

Charging your robot

Your robot will return to the dock whenever it needs to recharge during a cleaning routine. Once it is sufficiently charged, it will then resume cleaning where it left off.

Standby mode

Your robot uses a small amount of power whenever it is on the dock. You can put it in a further-reduced power state when not in use by pressing  for 10 seconds. To exit Low Power mode, short press .

NOTE:

Cleaning cannot be started from the mobile app while in Low Power mode.

Storing your robot

For long-term storage, turn off your robot by removing it from the dock, then press and hold the  button and bumper together for 10 seconds. Store in a cool, dry place.

Dock LED indicator

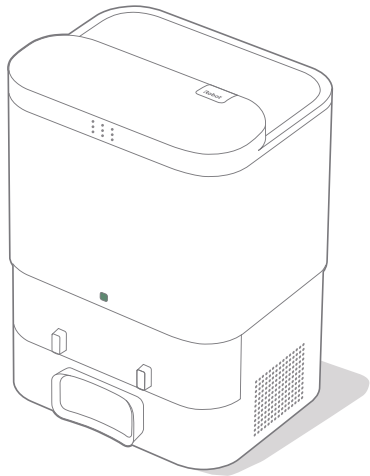

Solid white: Charging

Solid red: Bag full or not installed

NOTE:

Software updates may adjust the actual LED behaviour on the robot and/or dock. Please visit global.irobot.com for the most up-to-date information.

Cleaning

Button controls



HOME

- Tap to send the robot home
- Press to pause cleaning
- Press when paused to dock
- Press to stop docking

POWER

- Tap to start/pause/resume cleaning
- Hold for 3 seconds to turn on
- Hold for 10 seconds to turn off

For more information, visit global.irobot.com

NOTE:

Roomba® robots are generally designed to be used on most floor types for vacuuming. We do not recommend using mopping functions on unsealed hardwood floors and certain laminate/vinyl planks due to potential water damage to the flooring and/or subfloor. For more info, please visit global.irobot.com.

Cleaning pattern

Your robot will automatically explore and clean your home. It will start by cleaning the perimeter of the room and it will then clean the remaining floor space in neat rows. It will return the dock at the end of a cleaning routine and whenever it needs to recharge.





Tips:

- Remove excess clutter from floors before cleaning.
- Use your robot frequently to maintain well-conditioned floors.

After 90 minutes of inactivity off the dock, your robot will automatically end its clean. If you are unsure if it is finished or paused, visit the Roomba® Home App to check on its status.

Spot clean

Place your robot near the designated area that you need spot cleaned. Tap  two times. Spot clean will clean a 1 m x 1 m square around the robot two times in perpendicular directions. After spot clean is complete, your robot will end its cleaning routine. Press  to send it back to its dock.

Auto-emptying

Your robot will automatically empty its dust bin at the end of each cleaning routine

NOTE:

It is highly recommended to use the Roomba® Home App for cleaning control. The mobile app can be used to clean specific rooms, set up cleaning routines and create automations and schedules.

Vacuuming

Initiate vacuum mode

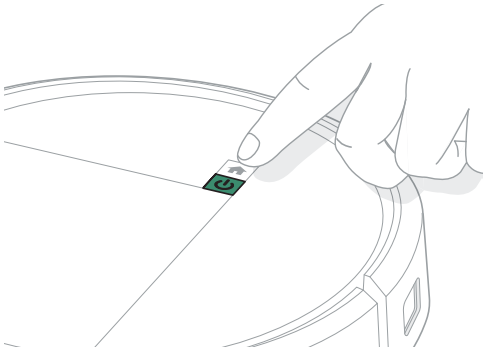

To vacuum, place the robot on the dock. Press  or use the Roomba® Home App to start your vacuum job.

 **IMPORTANT:**

It is recommended that you clean the dust bin at least once a week. Otherwise, the performance of the vacuum may be reduced.

Mopping

1

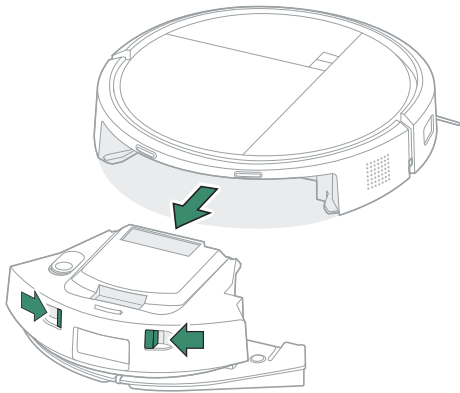

Press the Bin Release Button to remove the bin.

2

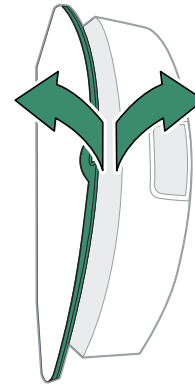

Remove pad plate.

3

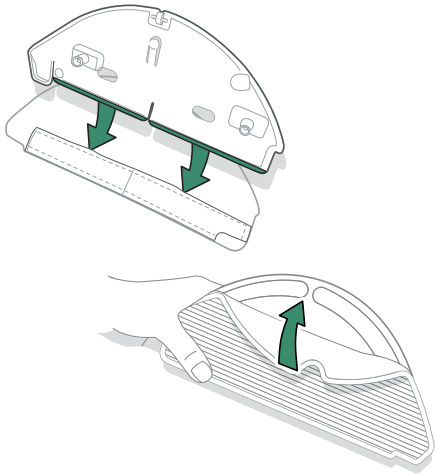

Lightly dampen the mop pad and attach to the pad plate.

4

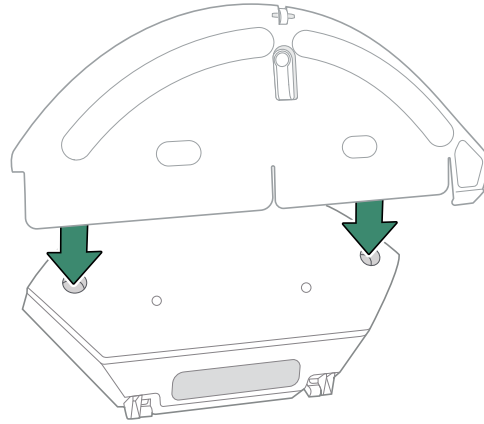

Reinstall mop pad plate on bin.

5

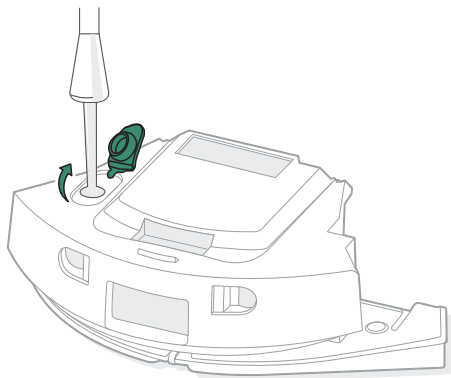

Fill bin with water.

6

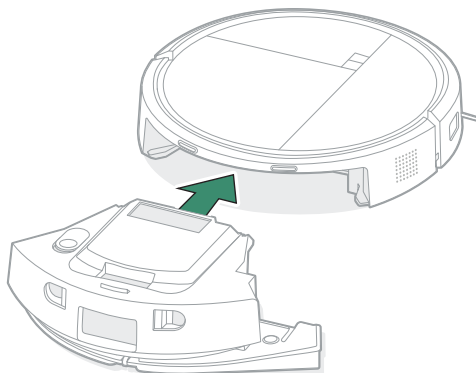



Place bin into robot.

Installing mop pad and mop pad plate

Align the mop pad plate attachment prongs with the mop pad plate attachment ports, then lower and insert the mop pad plate until you hear a click.

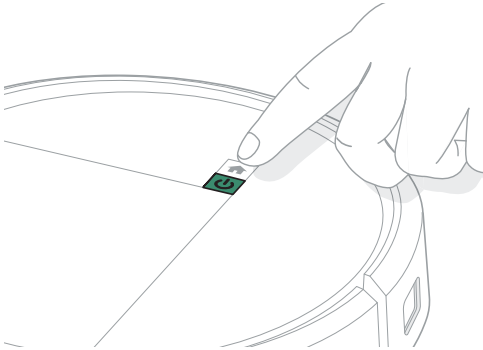
Initiate mop mode



To mop or vac+mop, place the robot on the dock or on the ground with the mop pad plate and mop pad installed. Press  to initiate a vac+mop job or use the Roomba® Home App to start your mop only or vac+mop job.

Care and maintenance for your robot

Keep your robot at optimal performance by periodically performing the following basic care and maintenance tasks. Cleaning performance and debris pick-up will be impacted without proper care and maintenance. If you notice the robot picking up less debris, empty the bin, clean the filter and clean the brushes.

View additional instructional videos in the Roomba® Home App.

Part	Care frequency	Replacement ^a .
Mop pad plate(s)	Automatically cleans after each use	Every 2–3 months or as needed
Mop pad(s)	Clean after mopping	Every 3–6 months.
Water tank	Empty after each use	
Dust bin	Empty and wash as needed	
Multi-Surface Brush	Clean 1x a week	Every 6–12 months
Charging contacts	Clean every 2 weeks or as needed	
Edge-Sweeping Brush	Clean every 2 weeks or as often as needed	Every 3–6 months
Filter	Clean 1x a week (2x a week with pet)	Every 3–6 months
Caster wheel	Clean every 2 weeks or as needed	
Sensors	Clean 1x a month or as needed	

Part	Care frequency	Replacement ^a .
Brush cover	Inspect every 6 months	Replace if worn or damaged

^aReplacement frequency may vary. Parts should be replaced if visible wear appears. If you think you need a replacement part, please contact iRobot® Customer Care for more information.

Cleaning the Edge-Sweeping Brush

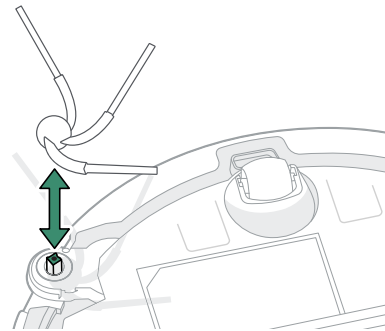

Pull to remove the Edge-Sweeping Brush. Remove any hair or debris, reinstall the Edge-Sweeping Brush.

*** IMPORTANT:**

It is recommended that you replace the Edge-Sweeping Brush every 3-6 months for optimal cleaning.

Cleaning the Multi-Surface Brush

1

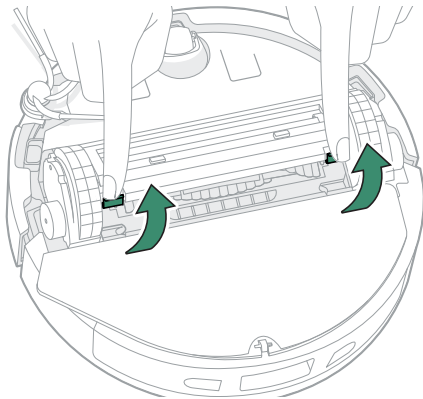

Pinch the brush cover release tabs, lift the tabs and remove any obstructions.

2

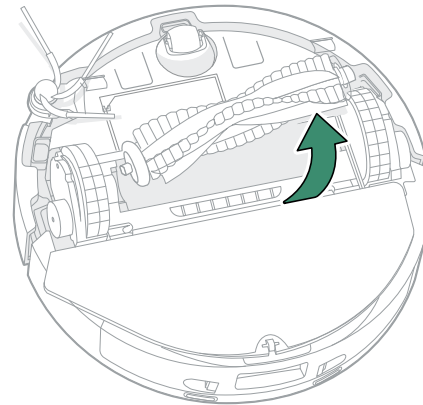

Remove the Multi-Surface Brush.

3

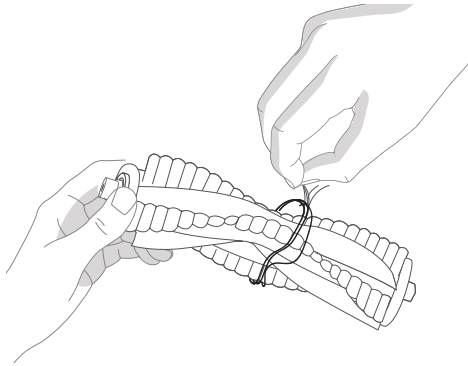

Remove any hair or debris.

4

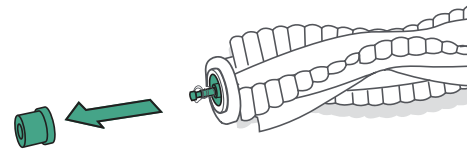

Remove end cap from the end of the brush.

5

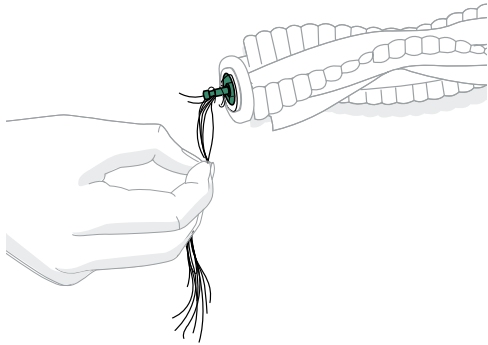

Remove any hair or debris that has collected beneath the cap.
Replace end cap.

6

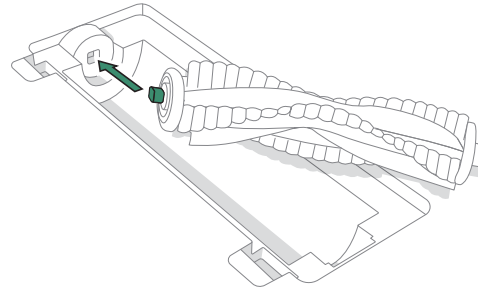

Reinstall the Multi-Surface Brush and brush cover in the robot.

*** IMPORTANT:**

It is recommended that you replace the multi-surface brush every 6-12 months for optimal cleaning performance.

NOTE:

For instructions on how to perform a deeper clean of the Multi-Surface Brush, see global.irobot.com.

Cleaning the front caster wheel

1

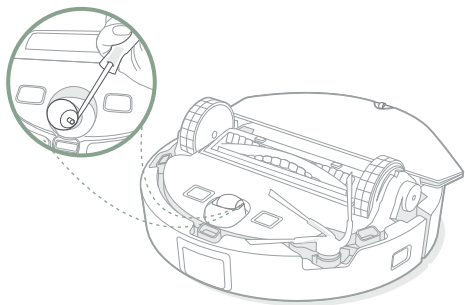

Remove hair and debris from the front caster wheel.

2

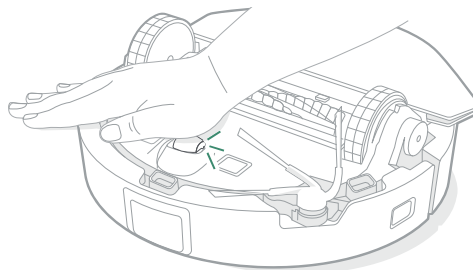

To reinsert the caster wheel, firmly press down with your palm until you hear a click.

*** IMPORTANT:**

A front wheel clogged with hair and debris could result in damage to your floor. If the wheel is not spinning freely after you have cleaned it, please contact Customer Care.

Cleaning the charging contacts and sensors

CHARGING CONTACTS

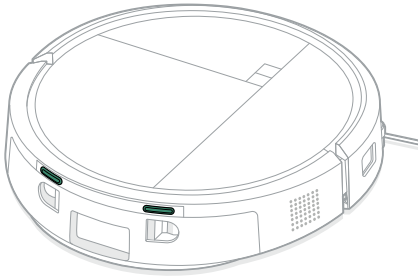

Remove the robot from the dock and wipe the charging contacts and sensors with a clean, dry cloth or lightly dampened melamine foam.

IMPORTANT:

Do not spray cleaning solution or water on the sensors or sensor openings.

SENSORS

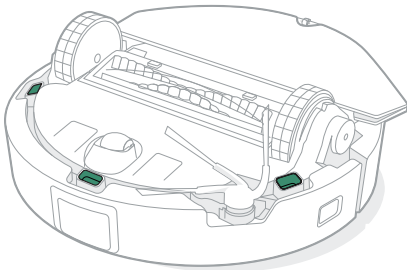

Cleaning the bin

1

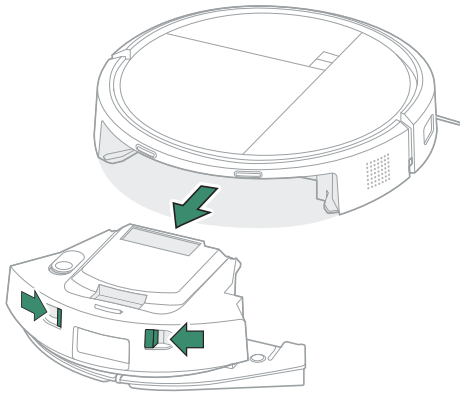

Press the Bin Release Button and pull up to remove the bin.

2

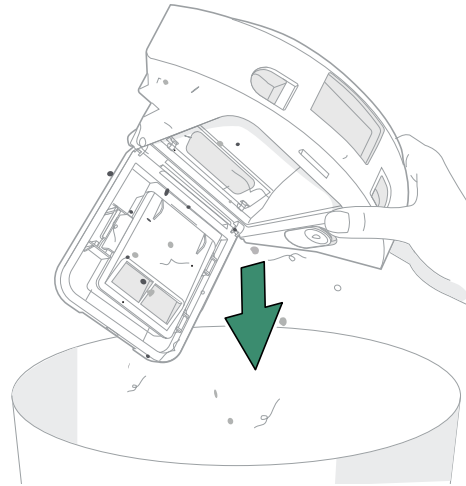

Open the dust bin over a rubbish bin. Empty and clean with cloth.

3

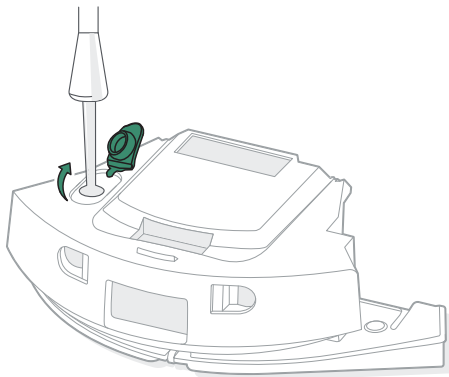

Rinse the bin using warm water.

4

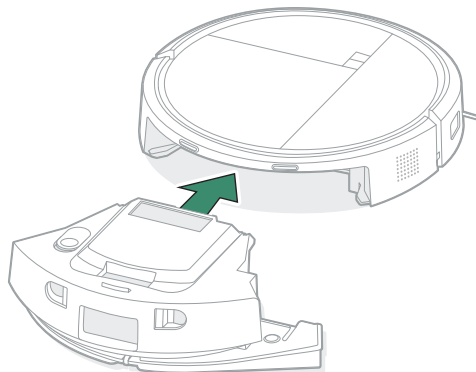

Place the bin back in the robot.

*** IMPORTANT:**

The bin is not dishwasher safe.

*** IMPORTANT:**

The bin is not dishwasher safe.

Cleaning the filter

1

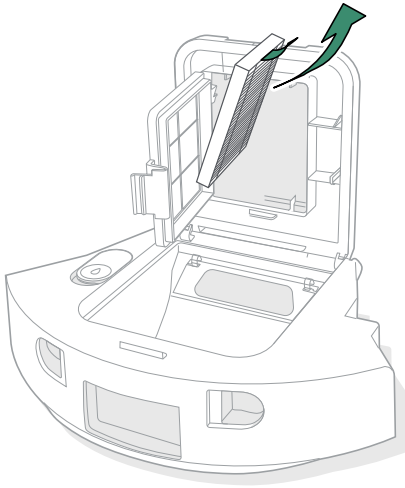

With the bin removed, open the bin door and remove the filter.

2

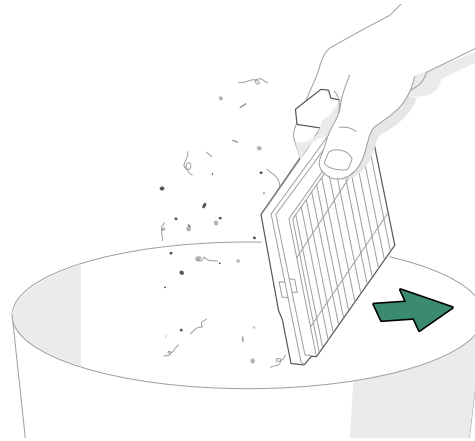

Remove debris by tapping the filter against a rubbish bin and/or clean it with a cleaning brush or clean cloth.

3

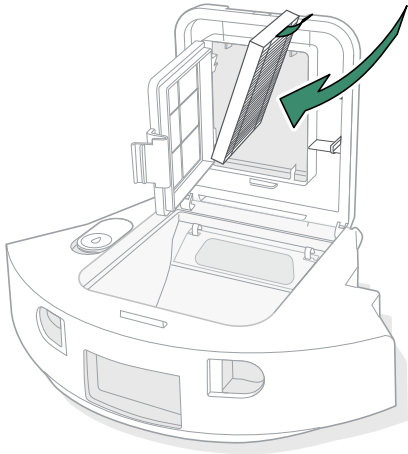

Reinsert filter.

Cleaning the mop pad

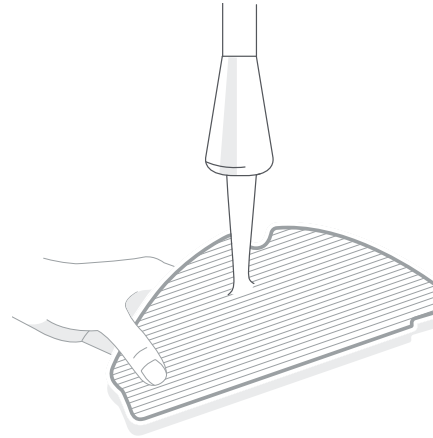

Thoroughly hand-wash the mop pad plate with cold water and let it air dry.

Cleaning the mop pad plate

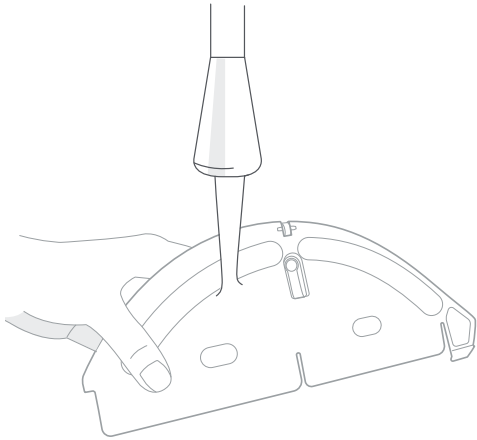

Thoroughly hand-wash the mop pad plate with cold water and let it air dry.

Care and maintenance for your AutoEmpty™ Dock

To keep your AutoEmpty™ Dock operating at optimal performance, perform the following care and maintenance tasks.

Part	Care frequency	Replacement frequency ^a
Charging contacts	Clean once a month	
Sensors	Clean once a month	
IR window	Clean once a month	
Dirt disposal bag		Bags should be replaced when full – prompted by the LED indicator on the dock and/or in the Roomba® Home App

^aReplacement frequency may vary. Parts should be replaced if visible wear appears. If you think you need a replacement part, please contact iRobot® Customer Care for more information.

Cleaning the charging contacts and IR window

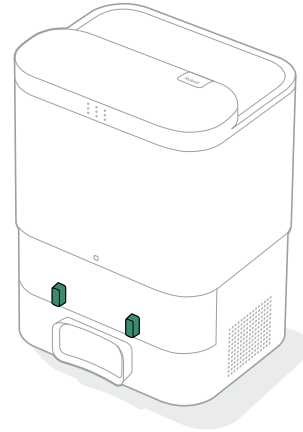

Unplug the dock. Inspect the components to make sure that they are clear of debris. Wipe with a clean, dry cloth.

*** IMPORTANT:**

Do not spray cleaning solution or water on the sensors or charging contacts.

Replacing the dirt disposal bag

1

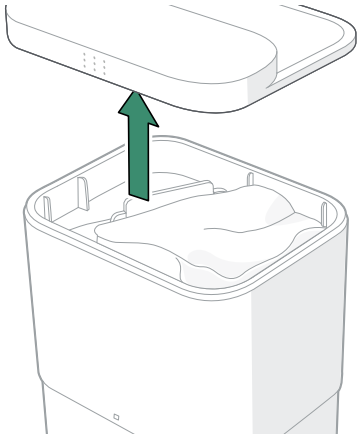

Lift up on the canister lid to open.

2

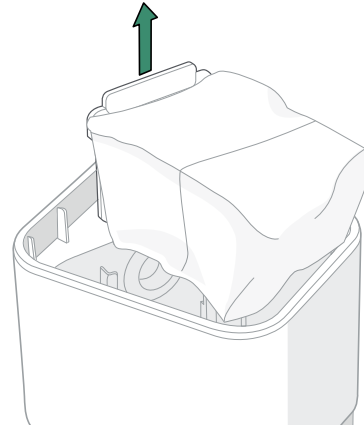

Pull up on the card to remove the bag from the canister. This will seal the bag so dust and debris cannot escape.

3

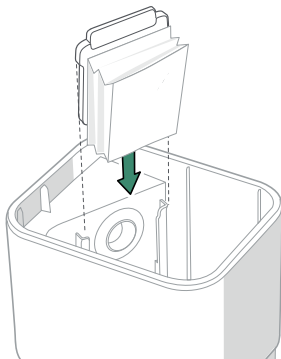

Install a new bag by sliding the card into the guide rails.

4

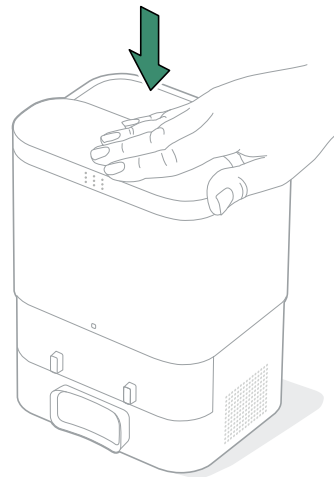

Press down on the lid, making sure that it is completely closed.

Removing debris from dock filter

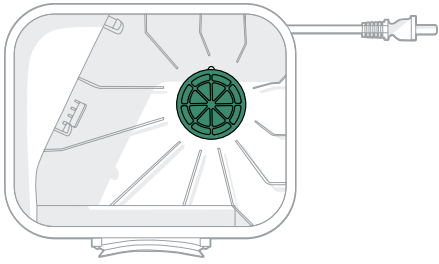

Inspect the blower cover for any lint or debris build-up, and wipe with a clean, dry cloth to remove debris.

Troubleshooting

Troubleshooting your robot

Your robot will alert you if something is wrong with a voice announcement or audio alert. The Roomba® Home App will also provide notifications with steps to troubleshoot any issues.

If you are unsure if the robot is finished or paused, consult the Roomba® Home App to check on its status.

Factory reset

To factory reset, press  for 5 seconds, don't release, and then (within 5 seconds) press  +  for 5 seconds.

Battery safety and posting

WARNING:

Lithium ion batteries and products that contain lithium ion batteries are subject to stringent transportation regulations. If you need to post this product for service, travel or any other reason, you **MUST** follow the below posting instructions.

- Battery **MUST** be turned off before posting.
- To turn off the battery, remove robot from the dock. Push in its bumper and hold it in that position while you press and hold the  button for 10 seconds or until the lights turn off.
- Package the robot securely for posting.

If you need further assistance, please visit your Roomba® Home App, contact our Customer Care team or visit global.irobot.com

Troubleshooting your AutoEmpty™ Dock

Your AutoEmpty™ Dock will tell you if something is wrong via an LED indicator on the front of the canister and through the Roomba® Home App. If the dock is not performing as expected, check the Roomba® Home App for troubleshooting steps.

LED indicator	Common error	How to fix
Solid red	Bag full or missing	Replace the bag if it is full or missing. Make sure that the bag is securely inserted. If the problem persists, remove any debris from the port on the back of your robot and front of the AutoEmpty™ Dock.

NOTE:

This product has been equipped with a thermal protector designed to protect against damage due to overheating. If the protector operates, the motor will stop running. If this happens, unplug the unit, allow it to cool for 30 minutes, clear any obstructions from the evacuation port and evacuation tube, then plug the unit back in.

Need further assistance? We're here to help.

Download the Roomba® Home App or visit global.irobot.com for product support or to contact your local support centre. If you need further assistance in the US & Canada, call the US Customer Care team on +1 (877) 855 8593

iRobot® USA Customer Care hours

Monday to Friday, 9 AM–9 PM Eastern Time

Saturday and Sunday, 9 AM–6 PM Eastern Time

Safety information

Please see the safety guide that came with your robot, or visit global.irobot.com

iRobot®

8 Crosby Drive, Bedford, MA 01730, USA. All rights reserved. iRobot, Roomba and PerfectEdge are registered trademarks of iRobot Corporation. AutoEmpty, AutoWash, StayClean and PrecisionVision are trademarks of iRobot Corporation. Wi-Fi and the Wi-Fi logo are registered trademarks of Wi-Fi Alliance. Apple and App Store are trademarks of Apple Inc., registered in the US and other countries. Google Play is a trademark of Google LLC.



WC# 4866774 vA